

GENERAL NOTES

1. THIS DRAWING IS TO BE READ IN CONJUNCTION WITH ALL RELEVANT ARCHITECTS, ENGINEERS AND SPECIALIST DRAWINGS AND SPECIFICATIONS
2. DO NOT SCALE FROM THIS DRAWING IN EITHER PAPER OR DIGITAL FORM. USE WRITTEN DIMENSIONS ONLY.

LEGEND

-  SITE BOUNDARY
-  HIGHWAY BOUNDARY (TRACED FROM HERTFORDSHIRE HIGHWAY BOUNDARIES AND LAND CHARGES FOR LYE LANE, BRICKET WOOD & PARK STREET LANE, DATED 15/06/2022.)
-  M25 MOTORWAY BELOW
-  EXISTING CARRIAGEWAY KERB TO BE REMOVED TO ALLOW FOR NEW FULL HEIGHT UPSTAND KERB.
-  EXTENT OF PROPOSED FOOTWAY / CARRIAGEWAY PASSING BAY
-  EXISTING DITCH TO BE CULVERTED AND BACKFILLED
-  EXISTING TREES TO BE PROTECTED DURING BACKFILLING OF THE DITCH. TREES LOCATED WITHIN OR ADJACENT TO THE PROPOSED FOOTWAY AND SURFACE WATER DRAIN TO BE REVIEWED WITH THE LOCAL HIGHWAY AUTHORITY AND ARBORICULTURALIST.

NOTES

ALL EXISTING SERVICES ARE TO BE LOCATED, IDENTIFIED AND PROTECTED PRIOR TO ANY WORKS. EXISTING SERVICE COVER TO BE RAISED TO MEET THE PROPOSED FINISHED LEVEL.

STATUTORY UNDERTAKERS ARE TO BE CONSULTED WITH PRIOR TO ANY WORKS.

ALL PROPOSED WORKS ARE TO BE APPROVED BY THE LOCAL HIGHWAY AUTHORITY, AND THE LEAD LOCAL FLOOD AGENCY.

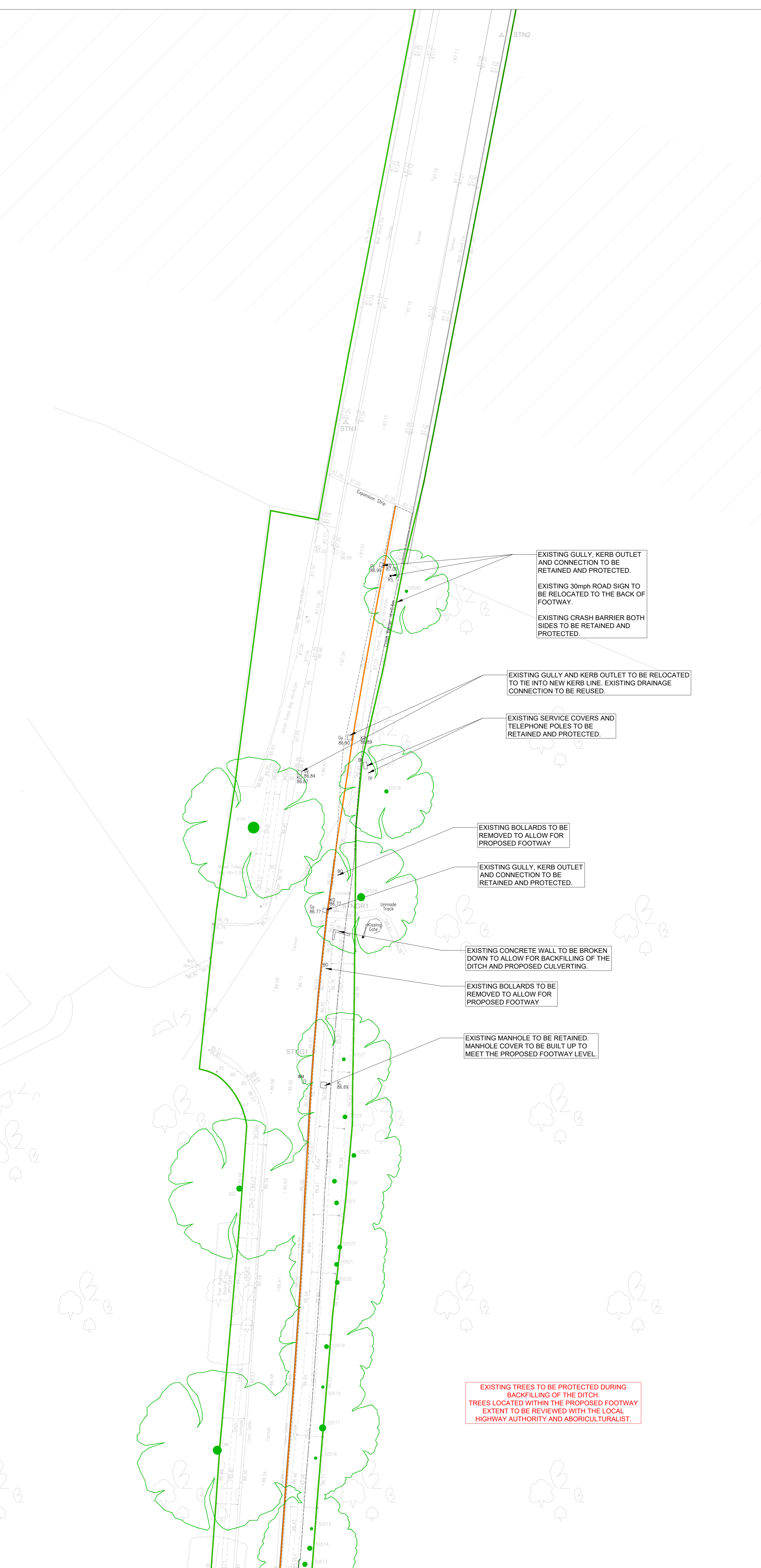

EXISTING GULLY, KERB OUTLET AND CONNECTION TO BE RETAINED AND PROTECTED.

EXISTING 30mph ROAD SIGN TO BE RELOCATED TO THE BACK OF FOOTWAY.

EXISTING CRASH BARRIER BOTH SIDES TO BE RETAINED AND PROTECTED.

EXISTING GULLY AND KERB OUTLET TO BE RELOCATED TO TIE INTO NEW KERB LINE. EXISTING DRAINAGE CONNECTION TO BE REUSED.

EXISTING SERVICE COVERS AND TELEPHONE POLES TO BE RETAINED AND PROTECTED.

EXISTING BOLLARDS TO BE REMOVED TO ALLOW FOR PROPOSED FOOTWAY

EXISTING GULLY, KERB OUTLET AND CONNECTION TO BE RETAINED AND PROTECTED.

EXISTING CONCRETE WALL TO BE BROKEN DOWN TO ALLOW FOR BACKFILLING OF THE DITCH AND PROPOSED CULVERTING.

EXISTING BOLLARDS TO BE REMOVED TO ALLOW FOR PROPOSED FOOTWAY

EXISTING MANHOLE TO BE RETAINED. MANHOLE COVER TO BE BUILT UP TO MEET THE PROPOSED FOOTWAY LEVEL.

EXISTING TREES TO BE PROTECTED DURING BACKFILLING OF THE DITCH. TREES LOCATED WITHIN THE PROPOSED FOOTWAY EXTENT TO BE REVIEWED WITH THE LOCAL HIGHWAY AUTHORITY AND ARBORICULTURALIST.

KEY PLAN

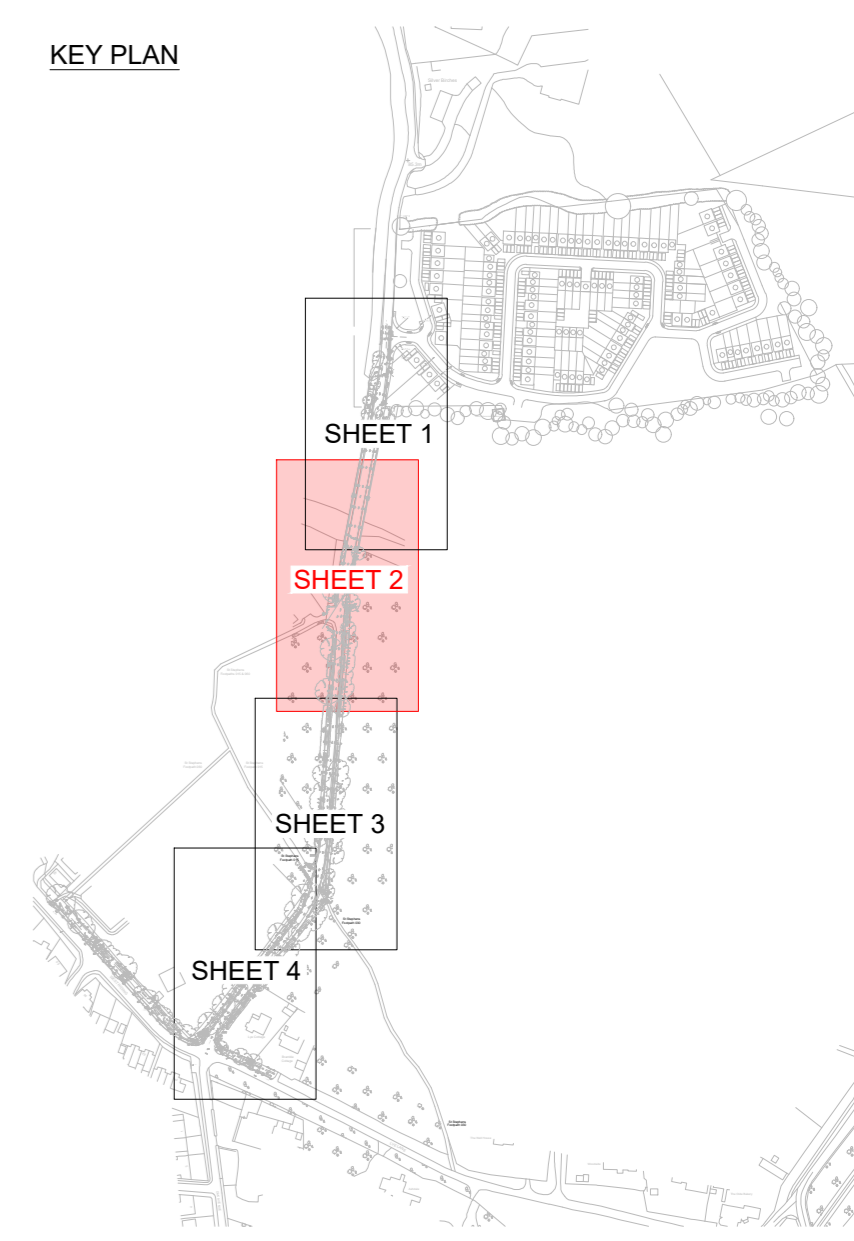

NOT FOR CONSTRUCTION

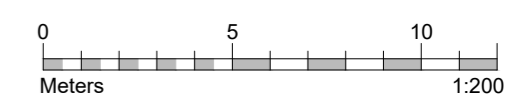

P03	07.05.24	REVISED FOLLOWING COMMENTS	NKR	PH
P02	15.04.24	REVISED FOLLOWING SITE VISIT DISCUSSIONS	NKR	PH
P01	04.03.24	ISSUED FOR REVIEW AND COMMENT	NKR	PH

conisbee Consulting Structural Engineers
Consulting Civil Engineers

London • Cambridge • Norwich
1-5 Offord St London N1 1DH
Telephone 020 7700 6666
www.conisbee.co.uk

Drawing Status PRE-PLANNING		Date	MAR 2024
Project LYE LANE, BRICKET WOOD ST ALBANS		Scale	1:200
Title PROPOSED SITE CLEARANCE SHEET 2		Drawn	NKR
Drawing No 231436-CON-XX-00-SK-C-0006		Engineer	NKR
		Project No	231436
		Revision	P03