

- GENERAL NOTES**
- THIS DRAWING IS TO BE READ IN CONJUNCTION WITH ALL RELEVANT ARCHITECTS, ENGINEERS AND SPECIALIST DRAWINGS AND SPECIFICATIONS
 - DO NOT SCALE FROM THIS DRAWING IN EITHER PAPER OR DIGITAL FORM. USE WRITTEN DIMENSIONS ONLY.

- LEGEND**
- SITE BOUNDARY
 - HIGHWAY BOUNDARY (TRACED FROM HERTFORDSHIRE HIGHWAY BOUNDARIES AND LAND CHARGES FOR LYE LANE, BRICKET WOOD & PARK STREET LANE, DATED 15/06/2022.)
 - M25 MOTORWAY BELOW
 - PROPOSED FULL HEIGHT UPSTAND EDGE OF CARRIAGEWAY KERB.
 - PROPOSED VEHICLE CROSSOVER KERB WITH 25mm UPSTAND
 - PROPOSED PEDESTRIAN DROPPED KERB LAID FLUSH
 - PROPOSED TRANSITION KERB.
 - PROPOSED FOOTWAY EDGING KERB.
 - EXISTING KERB LINE GEOMETRY.
 - PROPOSED SELF BINDING GRAVEL FOOTWAY CONSTRUCTION
 - PROPOSED ASPHALT VEHICLE CROSSOVER CONSTRUCTION.
 - PROPOSED PERMEABLE BLOCK PAVING CARRIAGEWAY PASSING BAY.
 - PROPOSED PEDESTRIAN DROPPED KERB.
 - PROPOSED PEDESTRIAN DROPPED KERB WITH TACTILE BLISTER PAVING.
 - EXISTING DITCH TO BE CULVERTED AND BACKFILLED
 - EXISTING TREES TO BE PROTECTED DURING BACKFILLING OF THE DITCH. TREES LOCATED WITHIN OR ADJACENT TO THE PROPOSED FOOTWAY AND SURFACE WATER DRAIN TO BE REVIEWED WITH THE LOCAL HIGHWAY AUTHORITY AND ABORICULTURALIST.
 - PROPOSED SURFACE WATER DRAINAGE MANHOLE
 - PROPOSED PERFORATED SURFACE WATER DRAINAGE CULVERT. CULVERT SIZE, GRADIENT, LEVELS AND SPECIFICATION TO BE CONFIRMED
 - PROPOSED SURFACE WATER HEADWALL
 - PROPOSED RETAINING AROUND EXISTING TREE TRUNKS. REFER TO SKETCH DETAIL DRAWING 231436-CON-XX-00-SK-C-0013
 - PROPOSED LOW LEVEL INSET SOLAR STREET LIGHTING TO BE INSTALLED FLUSH TO SURFACE IN 6m INTERVALS STAGGERED FROM FRONT TO BACK OF FOOTWAY. (LIGHTING TO BE IP67 WATERPROOF RATED, 150mm DIAMETER x 41mm DEPTH, 6000k DAY LIGHT WITH WHITE 210 LUMENS AND LITHIUM ION BATTERY. SPECIFICATION SUBJECT TO HCC APPROVAL.

- NOTES**
- ALL EXISTING SERVICES ARE TO BE LOCATED, IDENTIFIED AND PROTECTED PRIOR TO ANY WORKS.
- STATUTORY UNDERTAKERS ARE TO BE CONSULTED WITH PRIOR TO ANY WORKS.
- ALL PROPOSED WORKS ARE TO BE APPROVED BY THE LOCAL HIGHWAY AUTHORITY, AND THE LEAD LOCAL FLOOD AGENCY

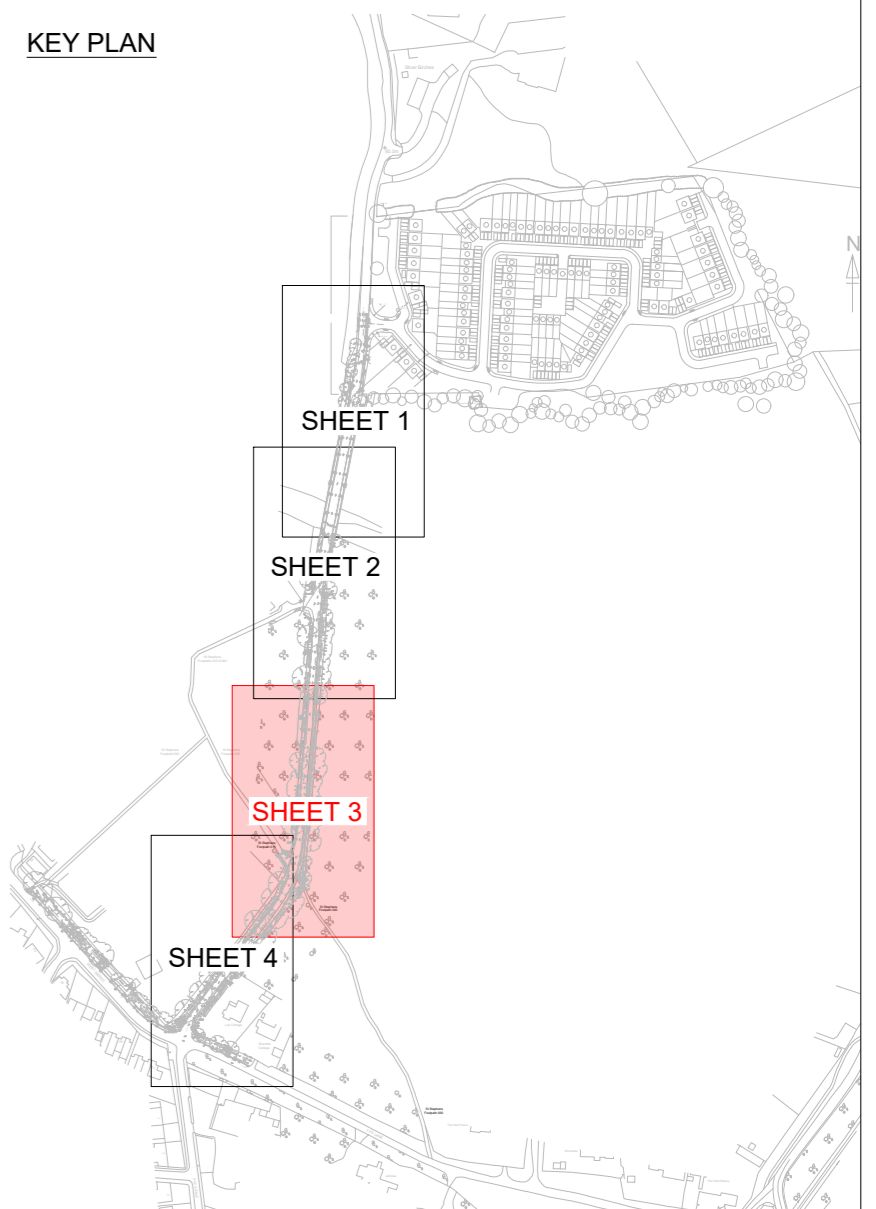

NOT FOR CONSTRUCTION

P03 07.05.24	REVISED FOLLOWING COMMENTS	NKR	PH
P02 15.04.24	REVISED FOLLOWING SITE VISIT DISCUSSIONS	NKR	PH
P01 04.03.24	ISSUED FOR REVIEW AND COMMENT	NKR	PH
Rev Date	Description	Drawn	Check

conisbee Consulting Structural Engineers
Consulting Civil Engineers

London • Cambridge • Norwich
1-5 Offord St London N1 1DH
Telephone 020 7700 6666
www.conisbee.co.uk

Drawing Status PRE-PLANNING	
Project LYE LANE, BRICKET WOOD ST ALBANS	Date MAR 2024
Title GENERAL ARRANGMENT PLAN SHEET 3	Scale 1:200
Drawing No 231436-CON-XX-00-SK-C-0003	Drawn NKR
	Engineer NKR
	Project No 231436
	Revision P03

phens
h 015

St Stephens
Footpath 015

St Stephens
Footpath 030

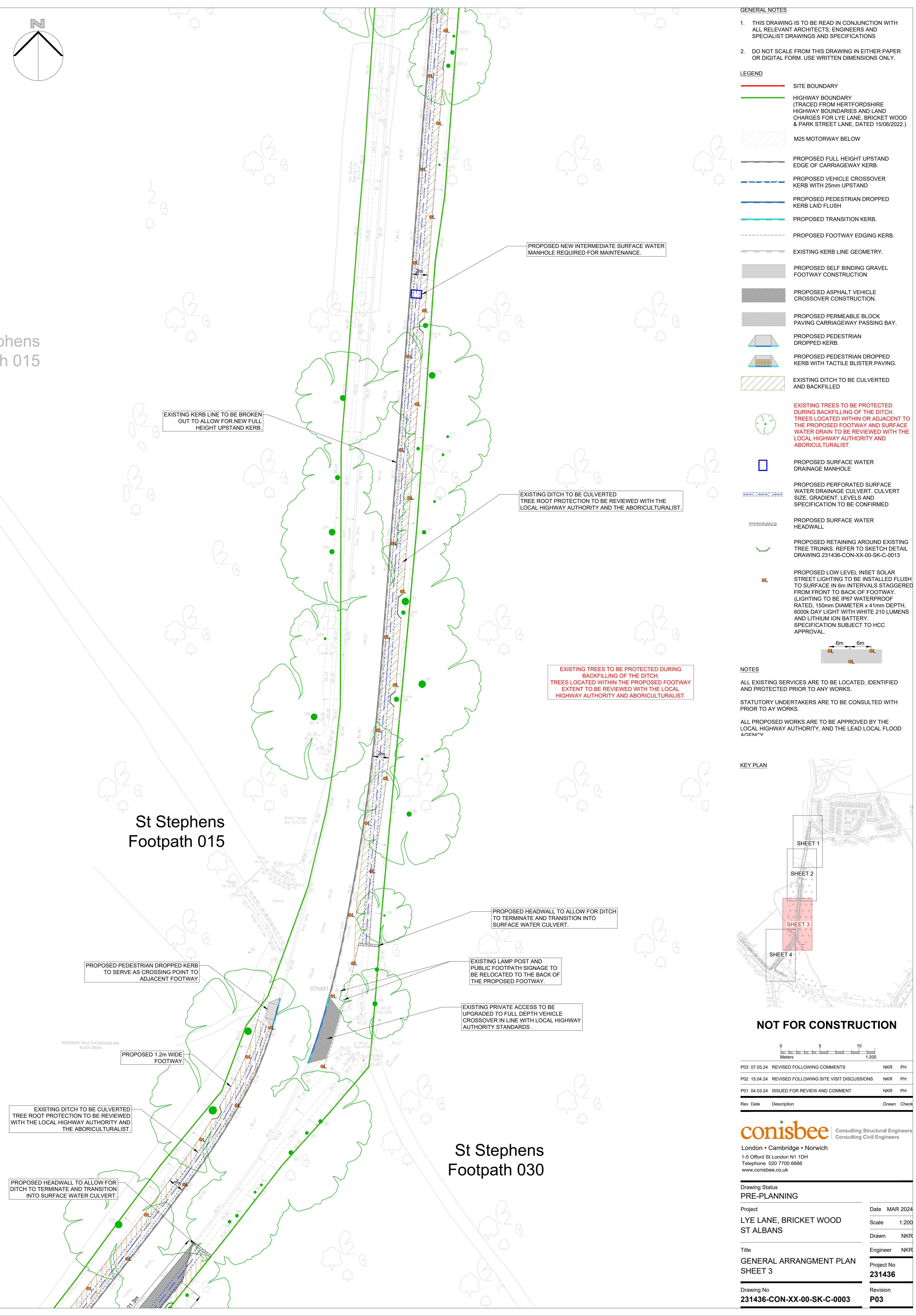

EXISTING KERB LINE TO BE BROKEN OUT TO ALLOW FOR NEW FULL HEIGHT UPSTAND KERB.

PROPOSED NEW INTERMEDIATE SURFACE WATER MANHOLE REQUIRED FOR MAINTENANCE.

EXISTING DITCH TO BE CULVERTED TREE ROOT PROTECTION TO BE REVIEWED WITH THE LOCAL HIGHWAY AUTHORITY AND THE ABORICULTURALIST.

EXISTING TREES TO BE PROTECTED DURING BACKFILLING OF THE DITCH. TREES LOCATED WITHIN THE PROPOSED FOOTWAY EXTENT TO BE REVIEWED WITH THE LOCAL HIGHWAY AUTHORITY AND ABORICULTURALIST.

PROPOSED HEADWALL TO ALLOW FOR DITCH TO TERMINATE AND TRANSITION INTO SURFACE WATER CULVERT.

EXISTING LAMP POST AND PUBLIC FOOTPATH SIGNAGE TO BE RELOCATED TO THE BACK OF THE PROPOSED FOOTWAY.

EXISTING PRIVATE ACCESS TO BE UPGRADED TO FULL DEPTH VEHICLE CROSSOVER IN LINE WITH LOCAL HIGHWAY AUTHORITY STANDARDS.

PROPOSED PEDESTRIAN DROPPED KERB TO SERVE AS CROSSING POINT TO ADJACENT FOOTWAY

PROPOSED 1.2m WIDE FOOTWAY

EXISTING DITCH TO BE CULVERTED TREE ROOT PROTECTION TO BE REVIEWED WITH THE LOCAL HIGHWAY AUTHORITY AND THE ABORICULTURALIST.

PROPOSED HEADWALL TO ALLOW FOR DITCH TO TERMINATE AND TRANSITION INTO SURFACE WATER CULVERT.

WOODBURY FIELD PLAYGROUND AND BLACK GREEN

Mixed Foliage
Avg Ht=2.0m

STNM1