

GENERAL NOTES

- THIS DRAWING IS TO BE READ IN CONJUNCTION WITH ALL RELEVANT ARCHITECTS, ENGINEERS AND SPECIALIST DRAWINGS AND SPECIFICATIONS
- DO NOT SCALE FROM THIS DRAWING IN EITHER PAPER OR DIGITAL FORM. USE WRITTEN DIMENSIONS ONLY.

LEGEND

- HIGHWAY BOUNDARY (TRACED FROM HERTFORDSHIRE HIGHWAY BOUNDARIES AND LAND CHARGES FOR LYE LANE, BRICKET WOOD & PARK STREET LANE, DATED 15/06/2022.)
- EXISTING GROUND LINE
- PROPOSED FINISHED GROUND LINE

DRAINAGE, PAVEMENT AND RETAINING OPTIONS TO BE AGREED WITH THE ARBORICULTURALIST, LLFA AND HIGHWAY AUTHORITY.

KEY PLAN

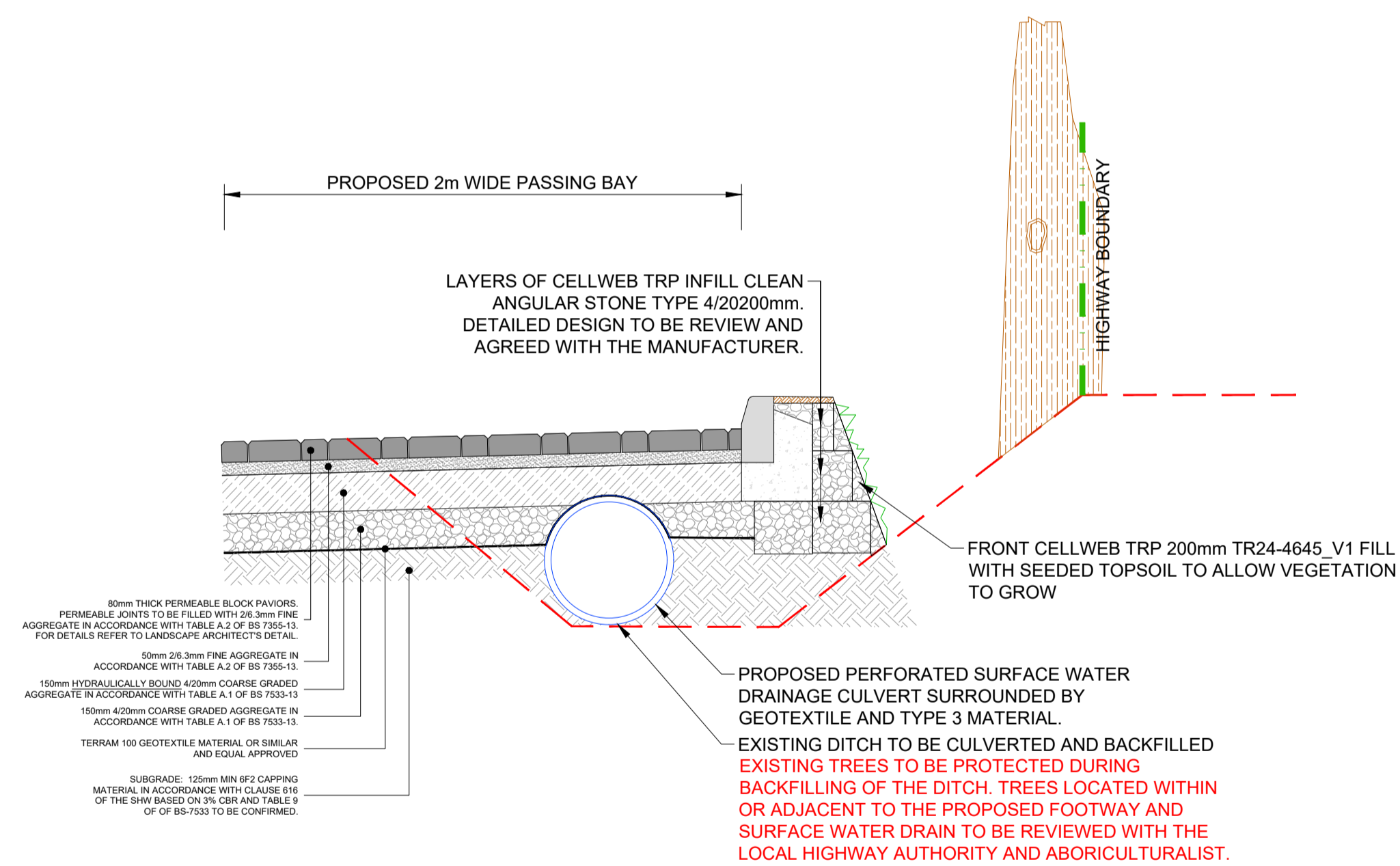
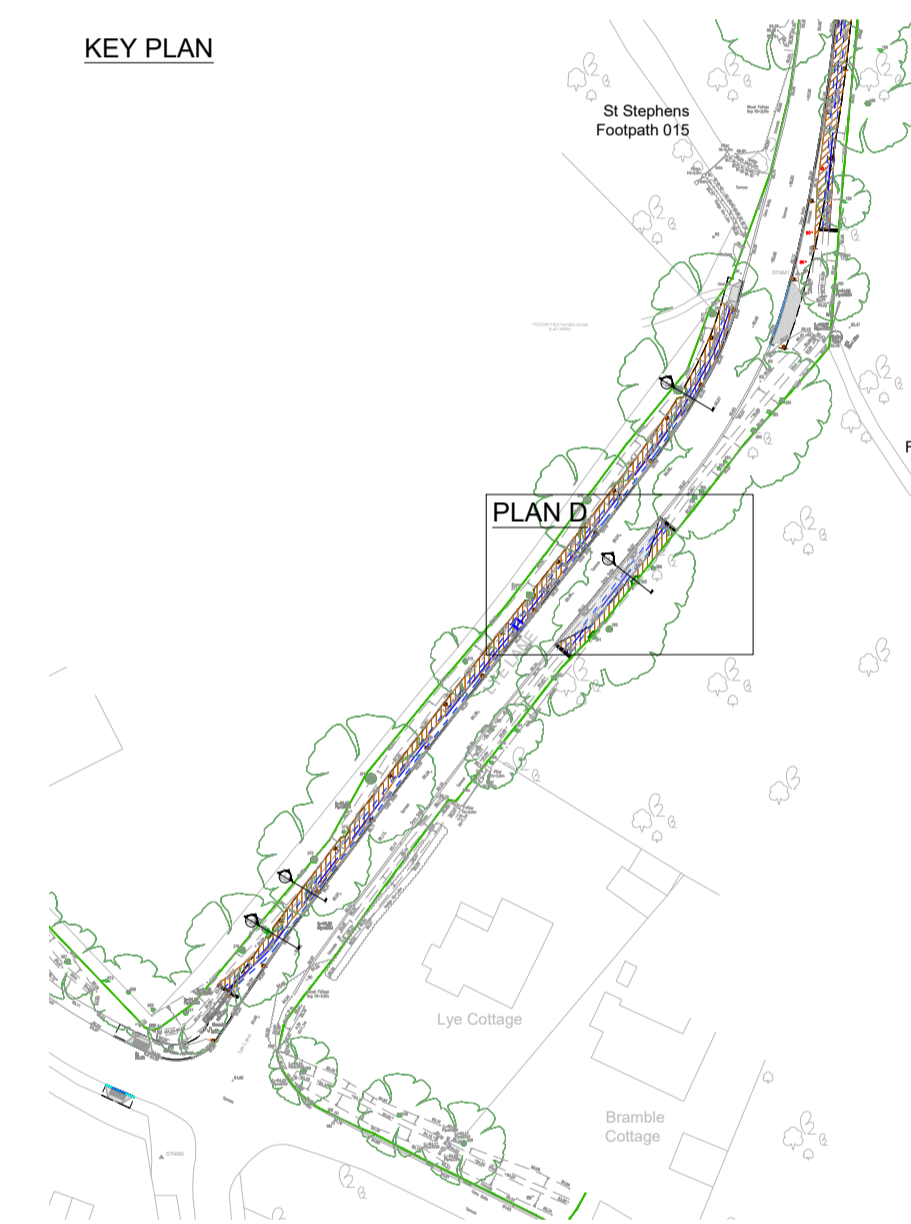

SECTION D

SCALE 1:20

PROPOSED 2m PASSING BAY TO LYE LANE WITH CELLWEB EMBANKMENT OVER TREE ROOT AREA

NOT FOR CONSTRUCTION

P01 07.05.24	ISSUED FOR REVIEW AND COMMENT	NKR	PH	
Rev	Date	Description	Drawn	Check

**conisbee** Consulting Structural Engineers  
Consulting Civil Engineers

London • Cambridge • Norwich  
1-5 Offord St London N1 1DH  
Telephone 020 7700 6666  
www.conisbee.co.uk

Drawing Status	
PRE-PLANNING	
Project	Date MAY 2024
LYE LANE, BRICKET WOOD ST ALBANS	Scale AS SHOWN
Drawn	NKR
Title	Engineer NKR
TYPICAL SECTION OF PROPOSED PASSING BAY TO LYE LANE	Project No <b>231436</b>
Drawing No <b>231436-CON-XX-00-SK-C-0014</b>	Revision <b>P01</b>