

# Brookbanks Consulting

Hertfordshire

Published 1951

Source map scale - 1:10,560

The historical maps shown were reproduced from maps predominantly held at the scale adopted for England, Wales and Scotland in the 1840's. In 1854 the 1:2,500 scale was adopted for mapping urban areas; these maps were used to update the 1:10,560 maps. The published date given therefore is often some years later than the surveyed date. Before 1938, all OS maps were based on the Cassini Projection, with independent surveys of a single county or group of counties, giving rise to significant inaccuracies in outlying areas. In the late 1940's, a Provisional Edition was produced, which updated the 1:10,560 mapping from a number of sources. The maps appear unfinished - with all military camps and other strategic sites removed. These maps were initially overprinted with the National Grid. In 1970, the first 1:10,000 maps were produced using the Transverse Mercator Projection. The revision process continued until recently, with new editions appearing every 10 years or so for urban areas.

## Map Name(s) and Date(s)

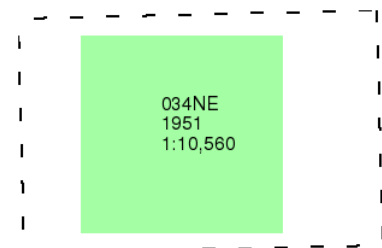

## Historical Map - Slice A

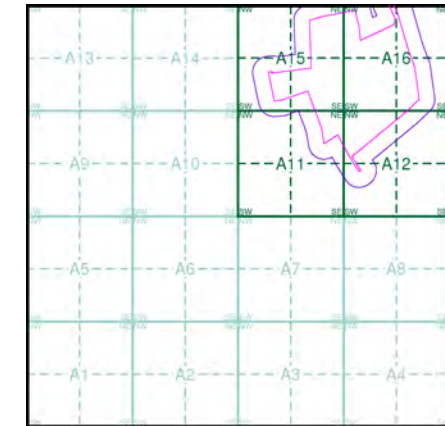

## Order Details

Order Number: 345196291\_1\_1  
 Customer Ref: PO01119  
 National Grid Reference: 515040, 209440  
 Slice: A  
 Site Area (Ha): 51.71  
 Search Buffer (m): 1000

## Site Details

St Albans

**Landmark**  
 INFORMATION GROUP

Tel: 0844 844 9952  
 Fax: 0844 844 9951  
 Web: www.envirocheck.co.uk

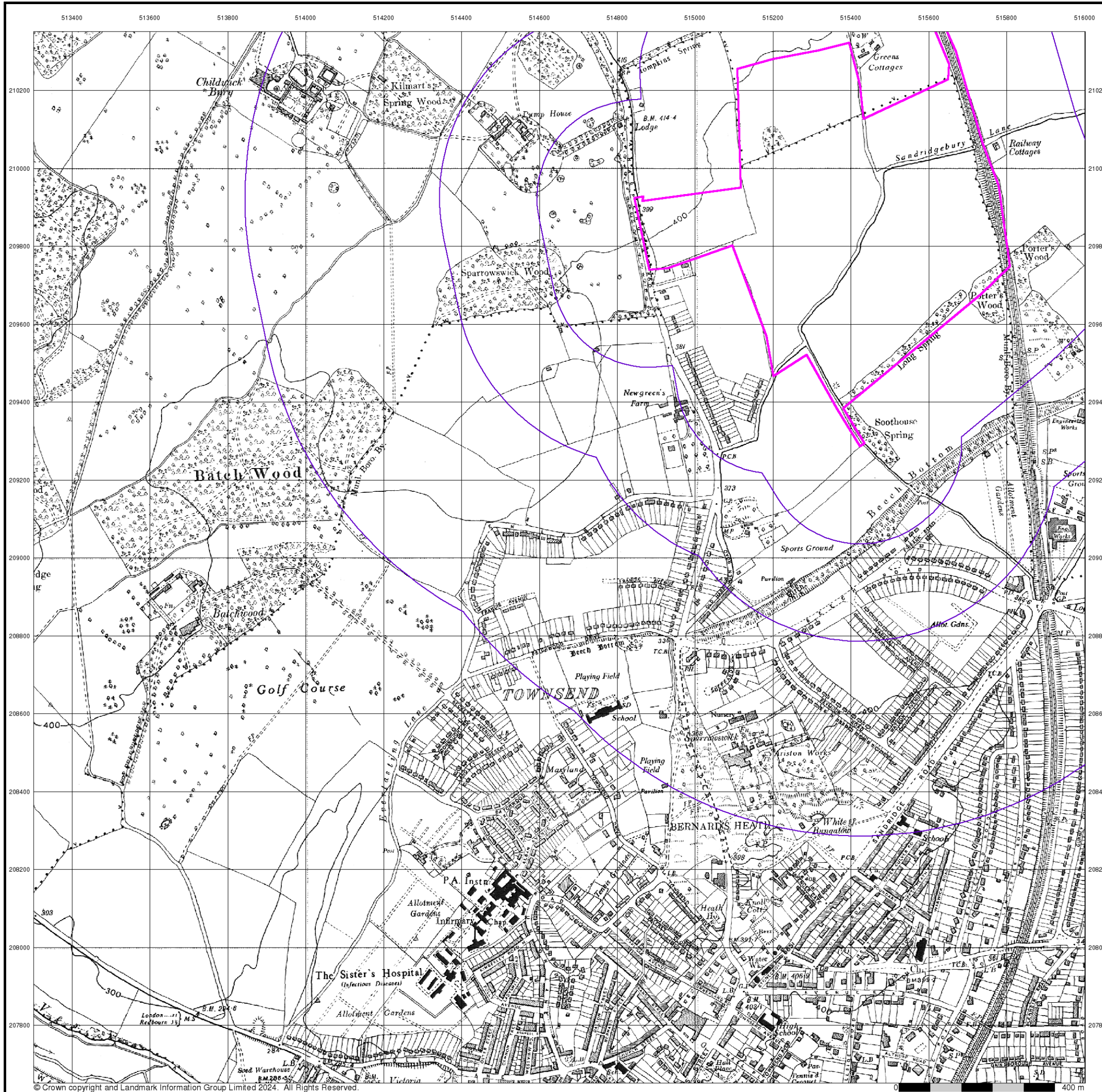

## Ordnance Survey Plan

Published 1960

Source map scale - 1:10,000

The historical maps shown were reproduced from maps predominantly held at the scale adopted for England, Wales and Scotland in the 1840's. In 1854 the 1:2,500 scale was adopted for mapping urban areas; these maps were used to update the 1:10,560 maps. The published date given therefore is often some years later than the surveyed date. Before 1938, all OS maps were based on the Cassini Projection, with independent surveys of a single county or group of counties, giving rise to significant inaccuracies in outlying areas. In the late 1940's, a Provisional Edition was produced, which updated the 1:10,560 mapping from a number of sources. The maps appear unfinished - with all military camps and other strategic sites removed. These maps were initially overprinted with the National Grid. In 1970, the first 1:10,000 maps were produced using the Transverse Mercator Projection. The revision process continued until recently, with new editions appearing every 10 years or so for urban areas.

### Map Name(s) and Date(s)

TL11SW	TL11SE
1960	1960
1:10,560	1:10,560
TL10NW	TL10NE
1960	1960
1:10,560	1:10,560

### Historical Map - Slice A

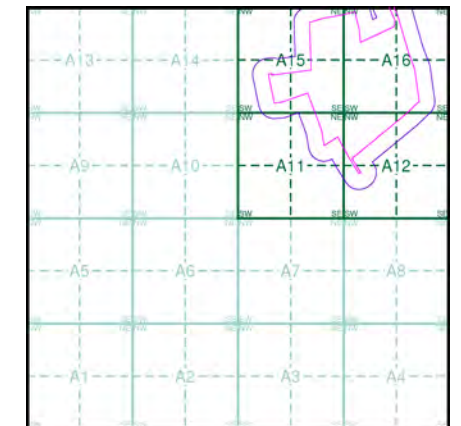

### Order Details

Order Number: 345196291\_1\_1  
 Customer Ref: PO01119  
 National Grid Reference: 515040, 209440  
 Slice: A  
 Site Area (Ha): 51.71  
 Search Buffer (m): 1000

### Site Details

St Albans

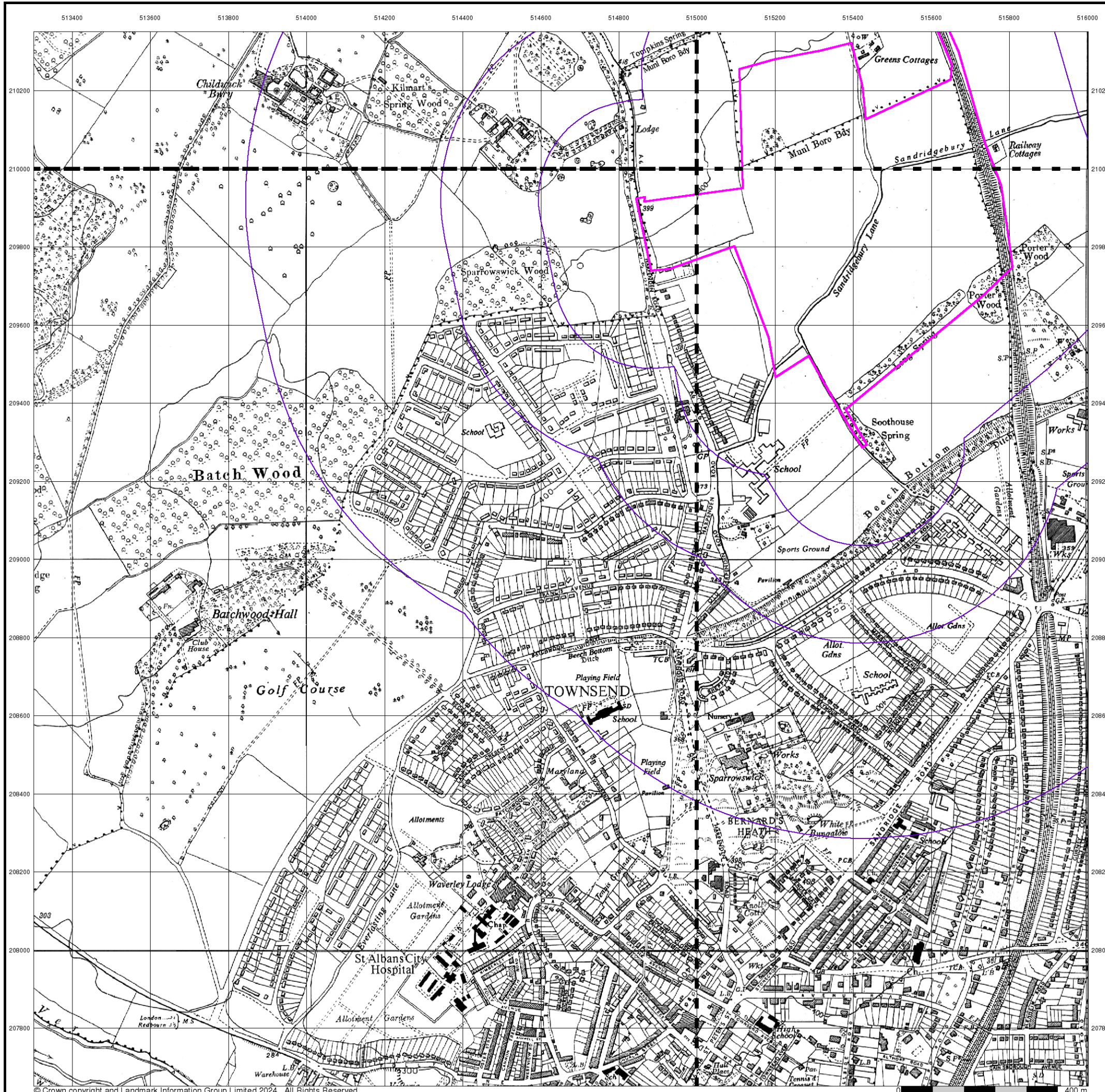

## Ordnance Survey Plan

Published 1965

Source map scale - 1:10,000

The historical maps shown were reproduced from maps predominantly held at the scale adopted for England, Wales and Scotland in the 1840's. In 1854 the 1:2,500 scale was adopted for mapping urban areas; these maps were used to update the 1:10,560 maps. The published date given therefore is often some years later than the surveyed date. Before 1938, all OS maps were based on the Cassini Projection, with independent surveys of a single county or group of counties, giving rise to significant inaccuracies in outlying areas. In the late 1940's, a Provisional Edition was produced, which updated the 1:10,560 mapping from a number of sources. The maps appear unfinished - with all military camps and other strategic sites removed. These maps were initially overprinted with the National Grid. In 1970, the first 1:10,000 maps were produced using the Transverse Mercator Projection. The revision process continued until recently, with new editions appearing every 10 years or so for urban areas.

### Map Name(s) and Date(s)

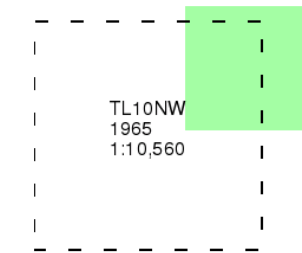

### Historical Map - Slice A

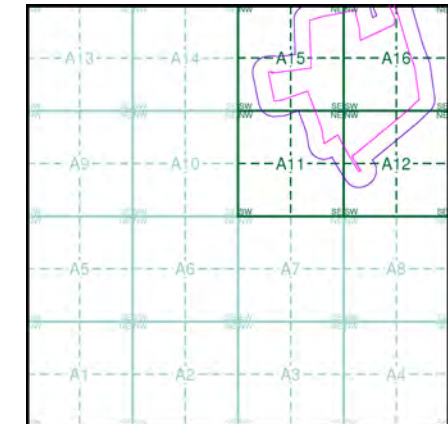

### Order Details

Order Number: 345196291\_1\_1  
 Customer Ref: PO01119  
 National Grid Reference: 515040, 209440  
 Slice: A  
 Site Area (Ha): 51.71  
 Search Buffer (m): 1000

### Site Details

St Albans

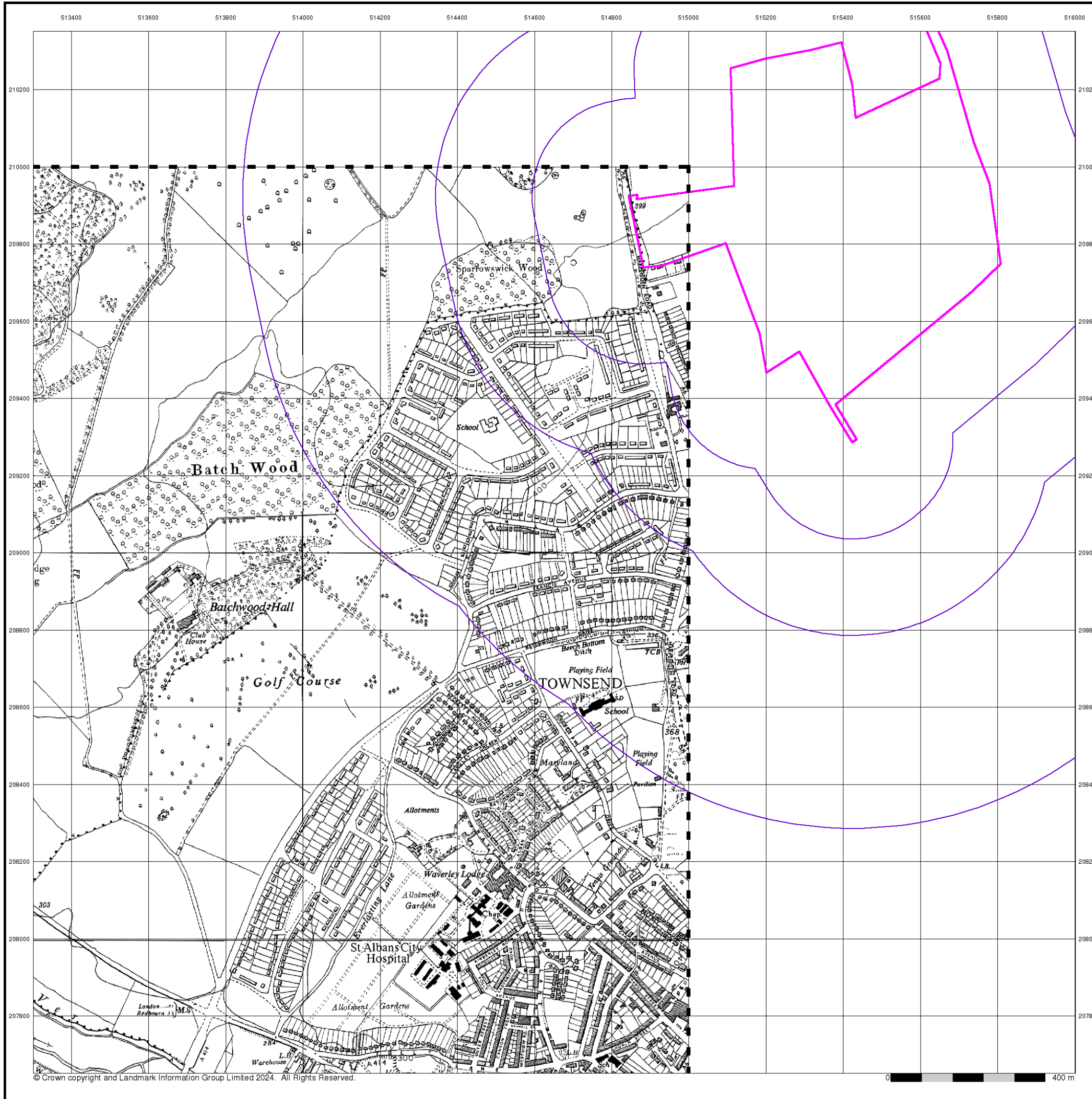

## Ordnance Survey Plan

Published 1976 - 1978

Source map scale - 1:10,000

The historical maps shown were reproduced from maps predominantly held at the scale adopted for England, Wales and Scotland in the 1840's. In 1854 the 1:2,500 scale was adopted for mapping urban areas; these maps were used to update the 1:10,560 maps. The published date given therefore is often some years later than the surveyed date. Before 1938, all OS maps were based on the Cassini Projection, with independent surveys of a single county or group of counties, giving rise to significant inaccuracies in outlying areas. In the late 1940's, a Provisional Edition was produced, which updated the 1:10,560 mapping from a number of sources. The maps appear unfinished - with all military camps and other strategic sites removed. These maps were initially overprinted with the National Grid. In 1970, the first 1:10,000 maps were produced using the Transverse Mercator Projection. The revision process continued until recently, with new editions appearing every 10 years or so for urban areas.

### Map Name(s) and Date(s)

TL11SW	1976	1:10,560
TL10NW	1978	1:10,000
TL10NE	1978	1:10,000

### Historical Map - Slice A

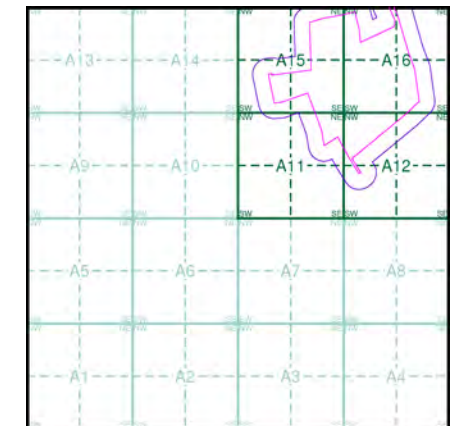

### Order Details

Order Number: 345196291\_1\_1  
 Customer Ref: PO01119  
 National Grid Reference: 515040, 209440  
 Slice: A  
 Site Area (Ha): 51.71  
 Search Buffer (m): 1000

### Site Details

St Albans

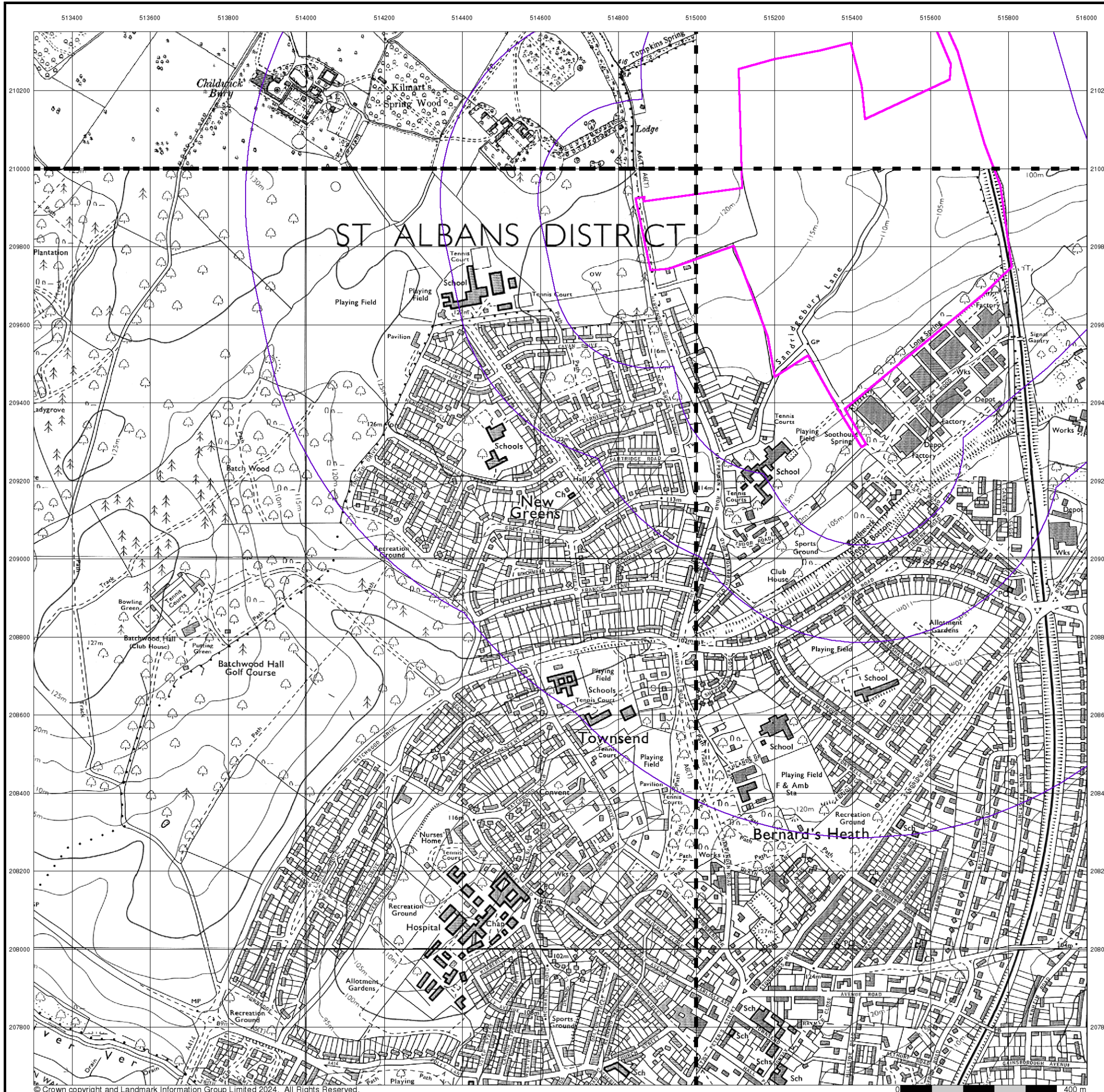

## Ordnance Survey Plan

Published 1981 - 1985

Source map scale - 1:10,000

The historical maps shown were reproduced from maps predominantly held at the scale adopted for England, Wales and Scotland in the 1840's. In 1854 the 1:2,500 scale was adopted for mapping urban areas; these maps were used to update the 1:10,560 maps. The published date given therefore is often some years later than the surveyed date. Before 1938, all OS maps were based on the Cassini Projection, with independent surveys of a single county or group of counties, giving rise to significant inaccuracies in outlying areas. In the late 1940's, a Provisional Edition was produced, which updated the 1:10,560 mapping from a number of sources. The maps appear unfinished - with all military camps and other strategic sites removed. These maps were initially overprinted with the National Grid. In 1970, the first 1:10,000 maps were produced using the Transverse Mercator Projection. The revision process continued until recently, with new editions appearing every 10 years or so for urban areas.

### Map Name(s) and Date(s)

TL11SW	TL11SE
1981	1981
1:10,000	1:10,000
	TL10NE
	1985
	1:10,000

### Historical Map - Slice A

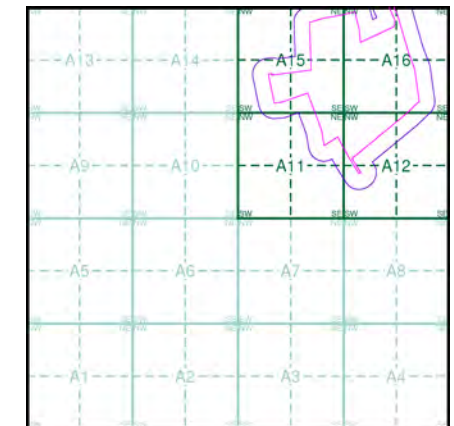

### Order Details

Order Number: 345196291\_1\_1  
 Customer Ref: PO01119  
 National Grid Reference: 515040, 209440  
 Slice: A  
 Site Area (Ha): 51.71  
 Search Buffer (m): 1000

### Site Details

St Albans



## Ordnance Survey Plan

Published 1992 - 1993

Source map scale - 1:10,000

The historical maps shown were reproduced from maps predominantly held at the scale adopted for England, Wales and Scotland in the 1840's. In 1854 the 1:2,500 scale was adopted for mapping urban areas; these maps were used to update the 1:10,560 maps. The published date given therefore is often some years later than the surveyed date. Before 1938, all OS maps were based on the Cassini Projection, with independent surveys of a single county or group of counties, giving rise to significant inaccuracies in outlying areas. In the late 1940's, a Provisional Edition was produced, which updated the 1:10,560 mapping from a number of sources. The maps appear unfinished - with all military camps and other strategic sites removed. These maps were initially overprinted with the National Grid. In 1970, the first 1:10,000 maps were produced using the Transverse Mercator Projection. The revision process continued until recently, with new editions appearing every 10 years or so for urban areas.

### Map Name(s) and Date(s)

TL11SW	1993	1:10,000
TL10NW	1992	1:10,000

### Historical Map - Slice A

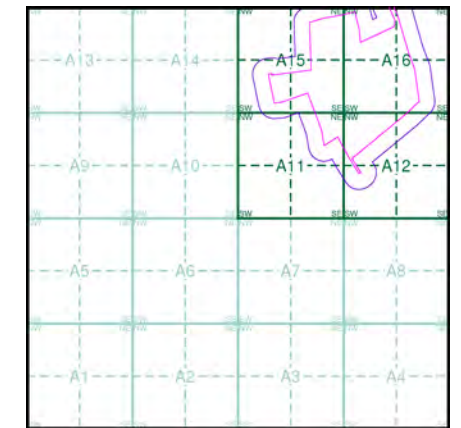

### Order Details

Order Number: 345196291\_1\_1  
 Customer Ref: PO01119  
 National Grid Reference: 515040, 209440  
 Slice: A  
 Site Area (Ha): 51.71  
 Search Buffer (m): 1000

### Site Details

St Albans

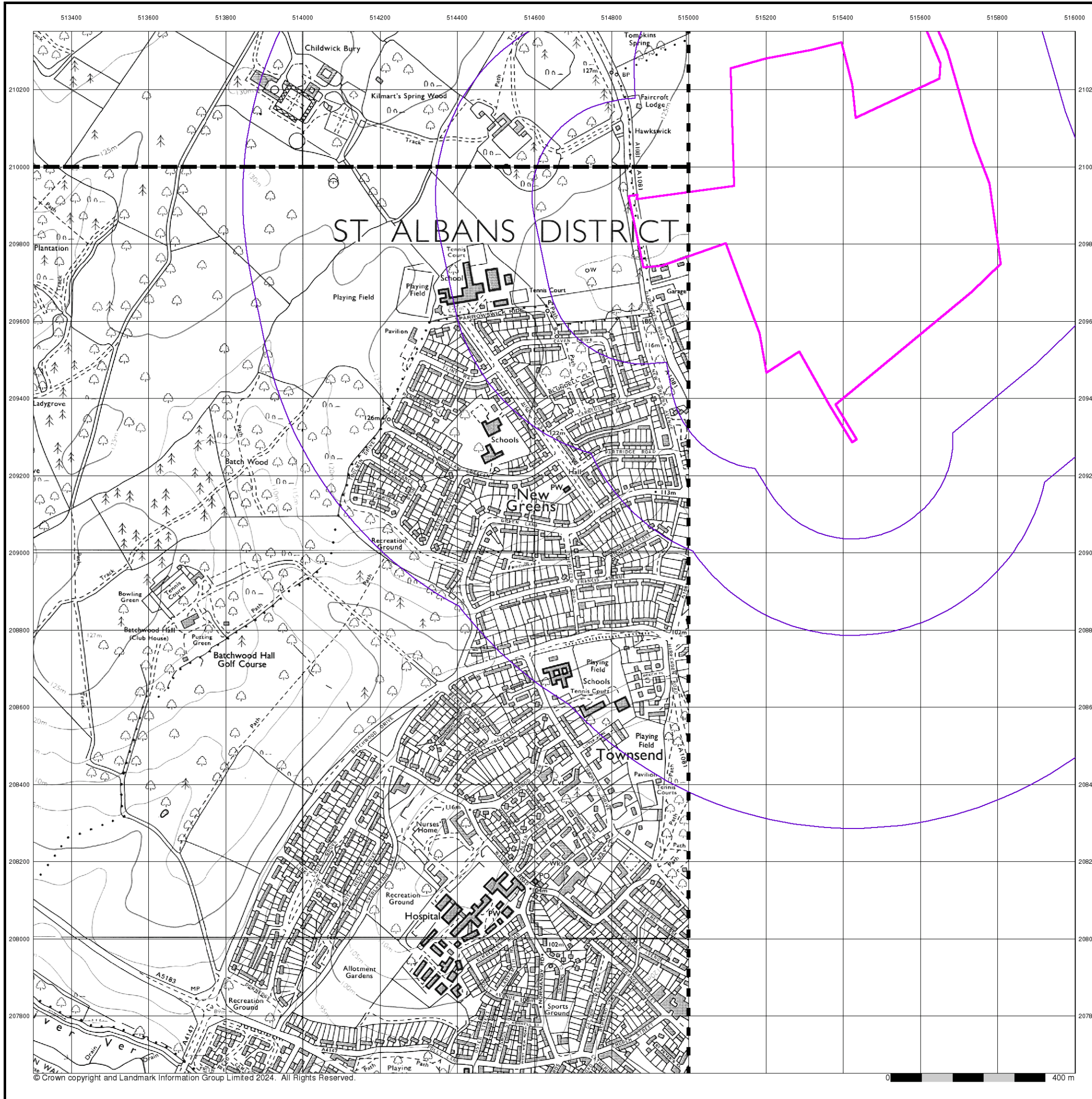

# Brookbanks Consulting

10k Raster Mapping

Published 1999

Source map scale - 1:10,000

The historical maps shown were produced from the Ordnance Survey's 1:10,000 colour raster mapping. These maps are derived from Landplan which replaced the old 1:10,000 maps originally published in 1970. The data is highly detailed showing buildings, fences and field boundaries as well as all roads, tracks and paths. Road names are also included together with the relevant road number and classification. Boundary information depiction includes county, unitary authority, district, civil parish and constituency.

### Map Name(s) and Date(s)

TL11SW	TL11SE
1999	1999
1:10,000	1:10,000
TL10NW	TL10NE
1999	1999
1:10,000	1:10,000

### Historical Map - Slice A

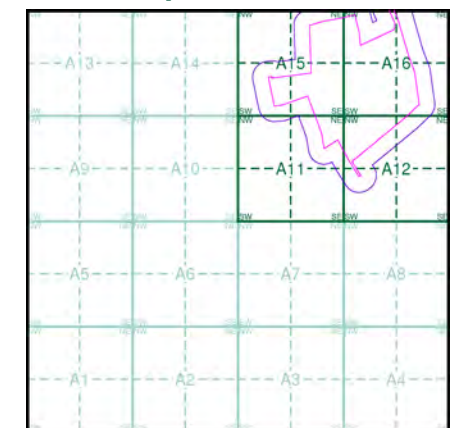

### Order Details

Order Number: 345196291\_1\_1  
 Customer Ref: PO01119  
 National Grid Reference: 515040, 209440  
 Slice: A  
 Site Area (Ha): 51.71  
 Search Buffer (m): 1000

### Site Details

St Albans

**Landmark**  
 INFORMATION GROUP

Tel: 0844 844 9952  
 Fax: 0844 844 9951  
 Web: www.envirocheck.co.uk

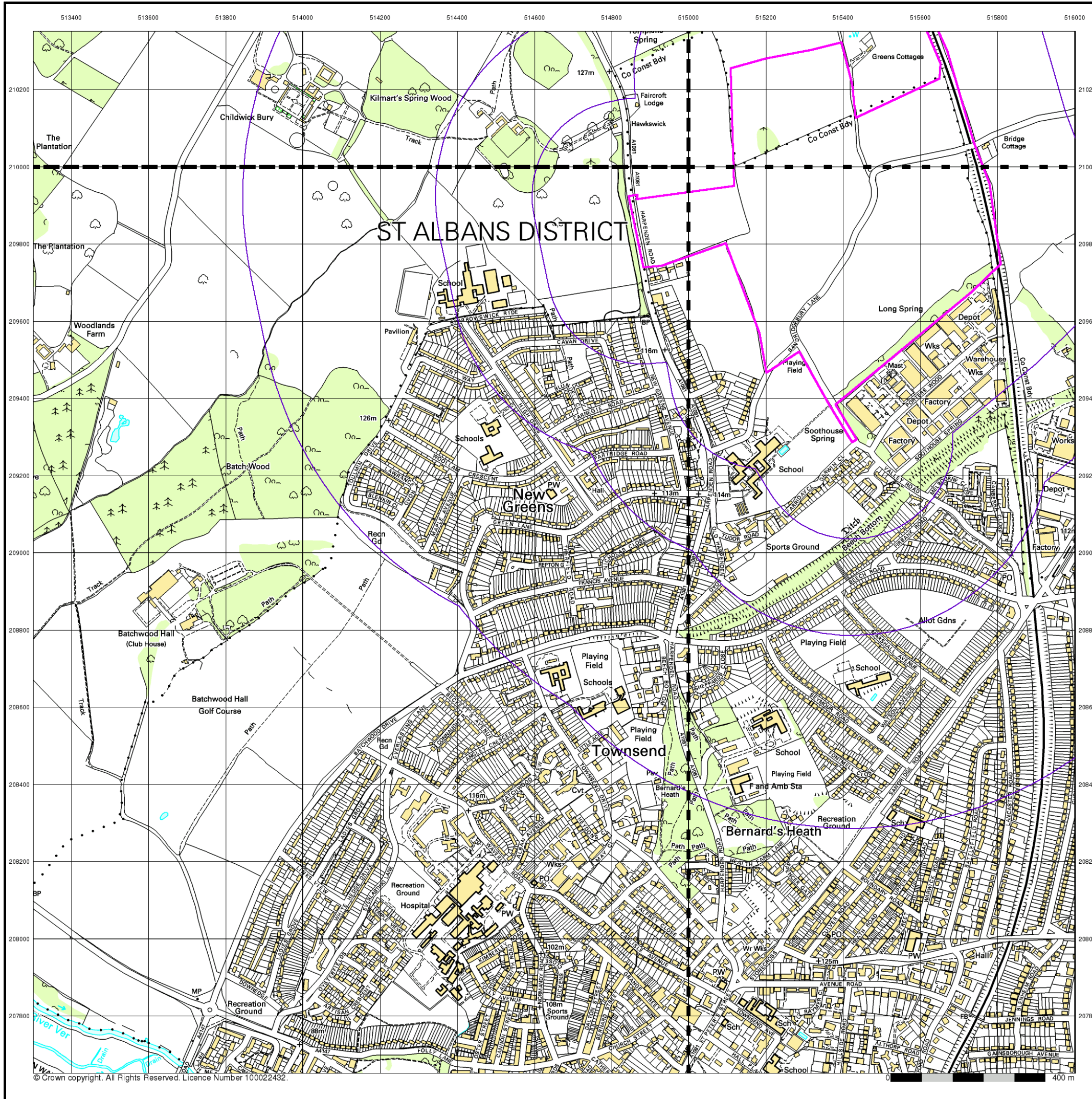

# Brookbanks Consulting

10k Raster Mapping

Published 2006

Source map scale - 1:10,000

The historical maps shown were produced from the Ordnance Survey's 1:10,000 colour raster mapping. These maps are derived from Landplan which replaced the old 1:10,000 maps originally published in 1970. The data is highly detailed showing buildings, fences and field boundaries as well as all roads, tracks and paths. Road names are also included together with the relevant road number and classification. Boundary information depiction includes county, unitary authority, district, civil parish and constituency.

## Map Name(s) and Date(s)

TL11SW	2006	1:10,000	TL11SE	2006	1:10,000
TL10NW	2006	1:10,000	TL10NE	2006	1:10,000

## Historical Map - Slice A

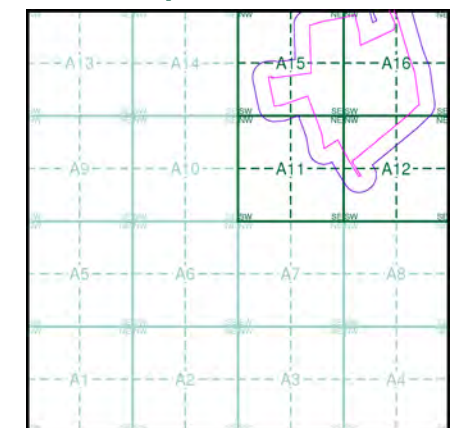

## Order Details

Order Number: 345196291\_1\_1  
 Customer Ref: PO01119  
 National Grid Reference: 515040, 209440  
 Slice: A  
 Site Area (Ha): 51.71  
 Search Buffer (m): 1000

## Site Details

St Albans

**Landmark**  
 INFORMATION GROUP

Tel: 0844 844 9952  
 Fax: 0844 844 9951  
 Web: www.envirocheck.co.uk





## VectorMap Local

Published 2024

Source map scale - 1:10,000

VectorMap Local (Raster) is Ordnance Survey's highest detailed 'backdrop' mapping product. These maps are produced from OS's VectorMap Local, a simple vector dataset at a nominal scale of 1:10,000, covering the whole of Great Britain, that has been designed for creating graphical mapping. OS VectorMap Local is derived from large-scale information surveyed at 1:1250 scale (covering major towns and cities), 1:2500 scale (smaller towns, villages and developed rural areas), and 1:10 000 scale (mountain, moorland and river estuary areas).

### Map Name(s) and Date(s)

TL11SW	TL11SE
2024	2024
Variable	Variable
TL10NW	TL10NE
2024	2024
Variable	Variable

### Historical Map - Slice A

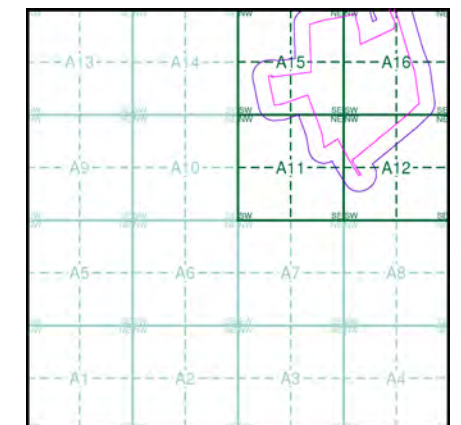

### Order Details

Order Number: 345196291\_1\_1  
 Customer Ref: PO01119  
 National Grid Reference: 515040, 209440  
 Slice: A  
 Site Area (Ha): 51.71  
 Search Buffer (m): 1000

### Site Details

St Albans



Hertfordshire

Published 1883

Source map scale - 1:10,560

The historical maps shown were reproduced from maps predominantly held at the scale adopted for England, Wales and Scotland in the 1840's. In 1854 the 1:2,500 scale was adopted for mapping urban areas; these maps were used to update the 1:10,560 maps. The published date given therefore is often some years later than the surveyed date. Before 1938, all OS maps were based on the Cassini Projection, with independent surveys of a single county or group of counties, giving rise to significant inaccuracies in outlying areas. In the late 1940's, a Provisional Edition was produced, which updated the 1:10,560 mapping from a number of sources. The maps appear unfinished - with all military camps and other strategic sites removed. These maps were initially overprinted with the National Grid. In 1970, the first 1:10,000 maps were produced using the Transverse Mercator Projection. The revision process continued until recently, with new editions appearing every 10 years or so for urban areas.

### Map Name(s) and Date(s)

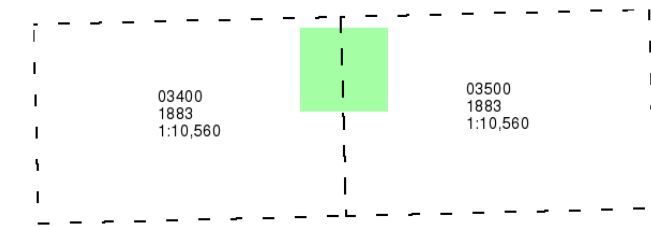

### Historical Map - Slice B

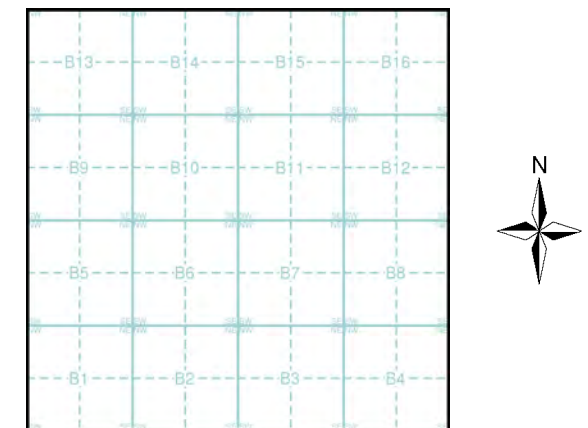

### Order Details

Order Number: 345196291\_1\_1  
 Customer Ref: PO01119  
 National Grid Reference: 516350, 209600  
 Slice: B  
 Site Area (Ha): 51.71  
 Search Buffer (m): 1000

### Site Details

St Albans

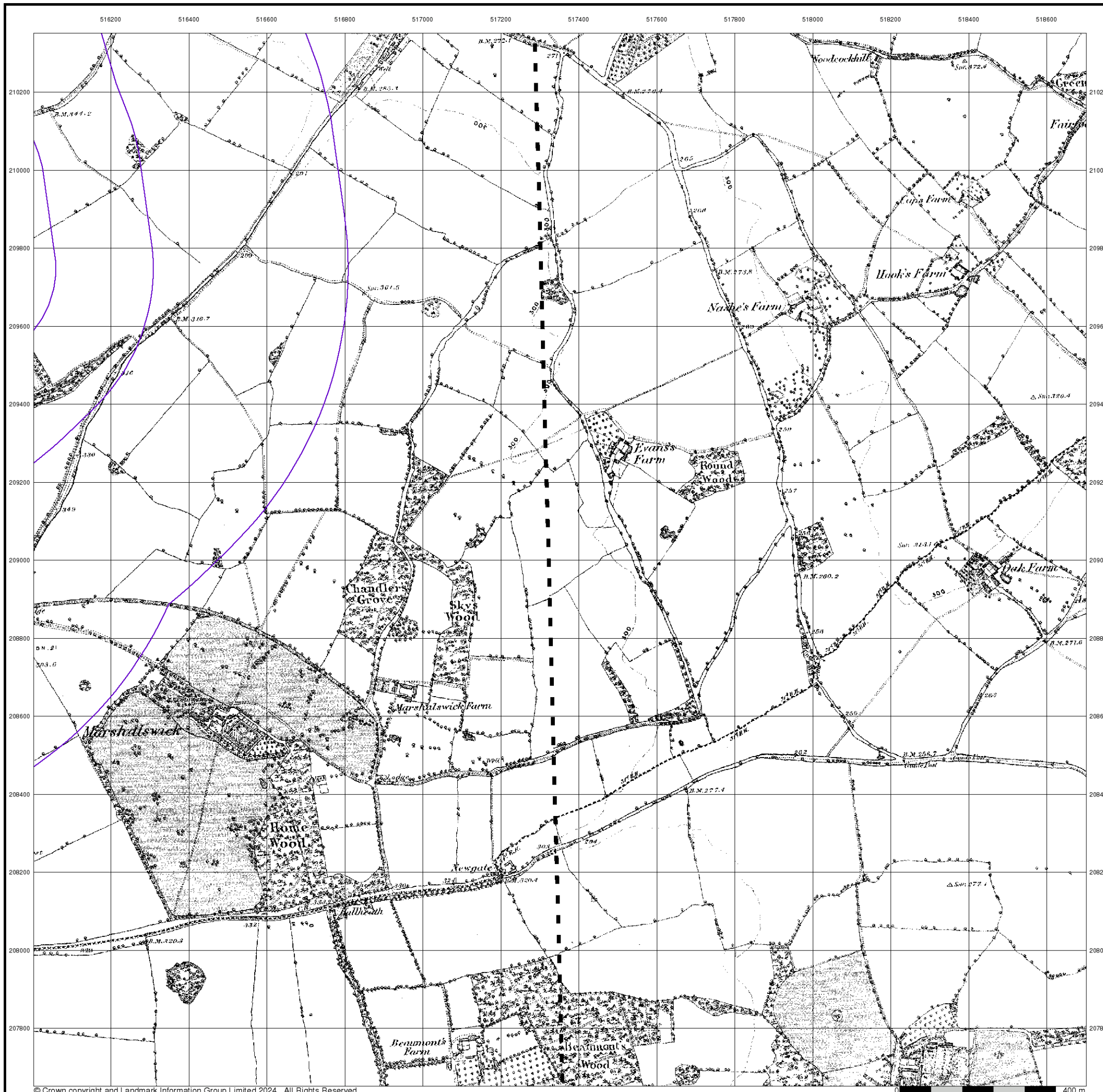

Hertfordshire

Published 1899

Source map scale - 1:10,560

The historical maps shown were reproduced from maps predominantly held at the scale adopted for England, Wales and Scotland in the 1840's. In 1854 the 1:2,500 scale was adopted for mapping urban areas; these maps were used to update the 1:10,560 maps. The published date given therefore is often some years later than the surveyed date. Before 1938, all OS maps were based on the Cassini Projection, with independent surveys of a single county or group of counties, giving rise to significant inaccuracies in outlying areas. In the late 1940's, a Provisional Edition was produced, which updated the 1:10,560 mapping from a number of sources. The maps appear unfinished - with all military camps and other strategic sites removed. These maps were initially overprinted with the National Grid. In 1970, the first 1:10,000 maps were produced using the Transverse Mercator Projection. The revision process continued until recently, with new editions appearing every 10 years or so for urban areas.

### Map Name(s) and Date(s)

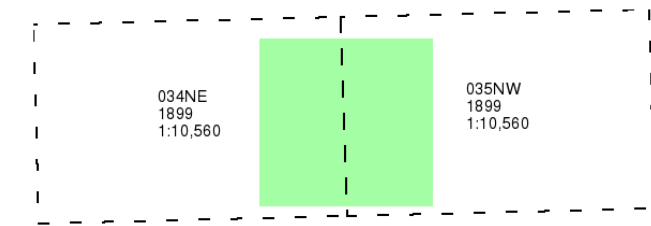

### Historical Map - Slice B

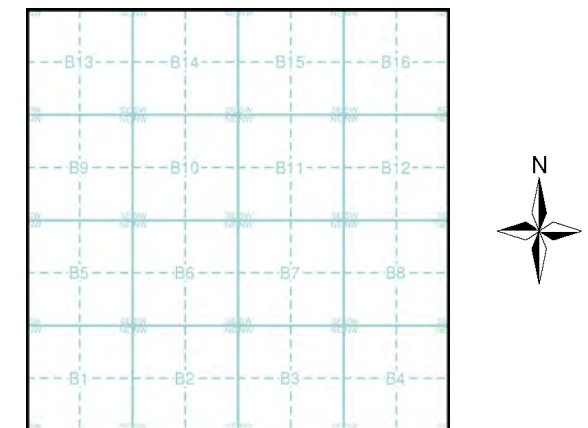

### Order Details

Order Number: 345196291\_1\_1  
 Customer Ref: PO01119  
 National Grid Reference: 516350, 209600  
 Slice: B  
 Site Area (Ha): 51.71  
 Search Buffer (m): 1000

### Site Details

St Albans

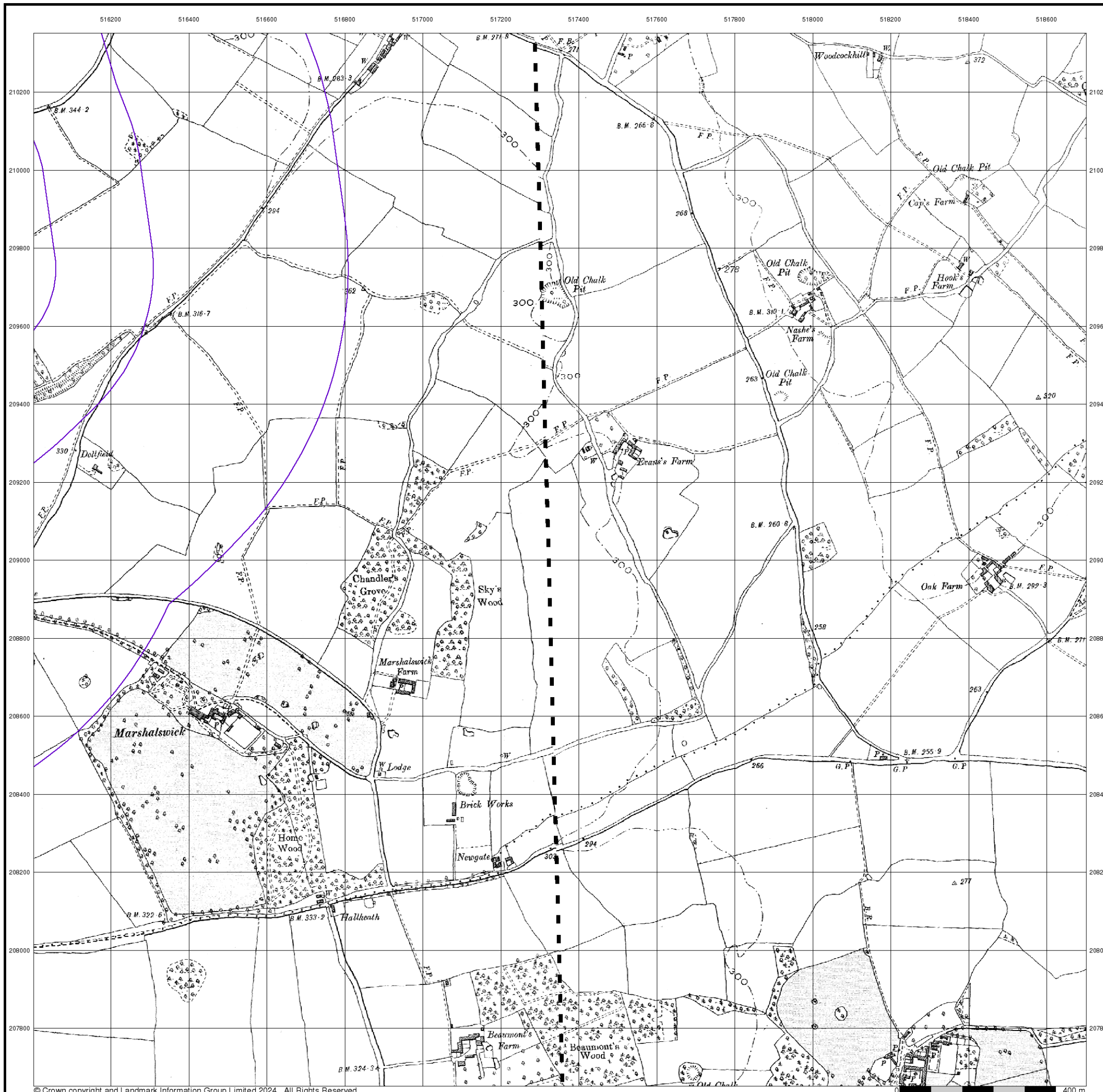

Hertfordshire

Published 1925

Source map scale - 1:10,560

The historical maps shown were reproduced from maps predominantly held at the scale adopted for England, Wales and Scotland in the 1840's. In 1854 the 1:2,500 scale was adopted for mapping urban areas; these maps were used to update the 1:10,560 maps. The published date given therefore is often some years later than the surveyed date. Before 1938, all OS maps were based on the Cassini Projection, with independent surveys of a single county or group of counties, giving rise to significant inaccuracies in outlying areas. In the late 1940's, a Provisional Edition was produced, which updated the 1:10,560 mapping from a number of sources. The maps appear unfinished - with all military camps and other strategic sites removed. These maps were initially overprinted with the National Grid. In 1970, the first 1:10,000 maps were produced using the Transverse Mercator Projection. The revision process continued until recently, with new editions appearing every 10 years or so for urban areas.

### Map Name(s) and Date(s)

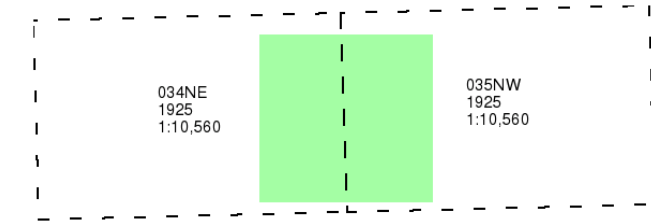

### Historical Map - Slice B

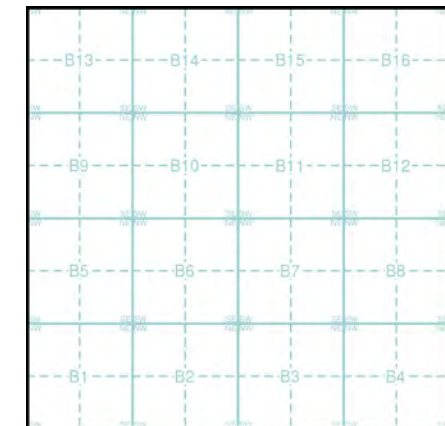

### Order Details

Order Number: 345196291\_1\_1  
 Customer Ref: PO01119  
 National Grid Reference: 516350, 209600  
 Slice: B  
 Site Area (Ha): 51.71  
 Search Buffer (m): 1000

### Site Details

St Albans

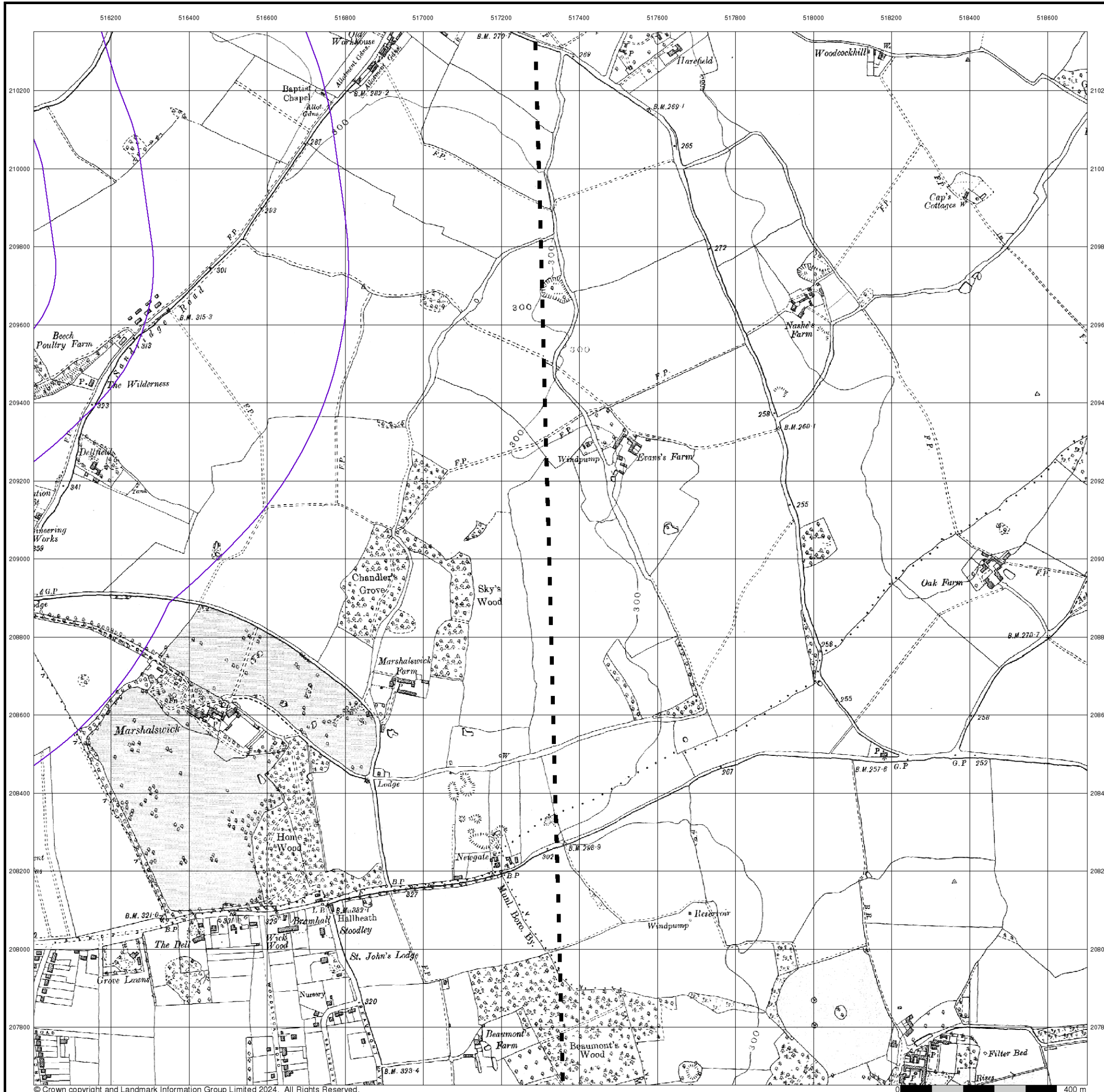

Hertfordshire

Published 1938 - 1939

Source map scale - 1:10,560

The historical maps shown were reproduced from maps predominantly held at the scale adopted for England, Wales and Scotland in the 1840's. In 1854 the 1:2,500 scale was adopted for mapping urban areas; these maps were used to update the 1:10,560 maps. The published date given therefore is often some years later than the surveyed date. Before 1938, all OS maps were based on the Cassini Projection, with independent surveys of a single county or group of counties, giving rise to significant inaccuracies in outlying areas. In the late 1940's, a Provisional Edition was produced, which updated the 1:10,560 mapping from a number of sources. The maps appear unfinished - with all military camps and other strategic sites removed. These maps were initially overprinted with the National Grid. In 1970, the first 1:10,000 maps were produced using the Transverse Mercator Projection. The revision process continued until recently, with new editions appearing every 10 years or so for urban areas.

### Map Name(s) and Date(s)

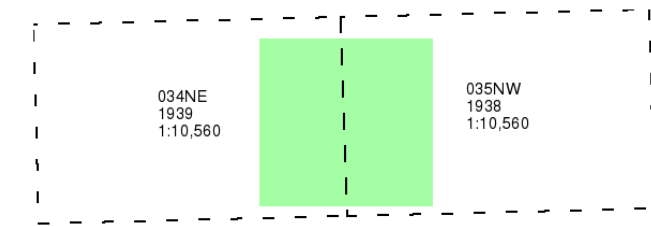

### Historical Map - Slice B

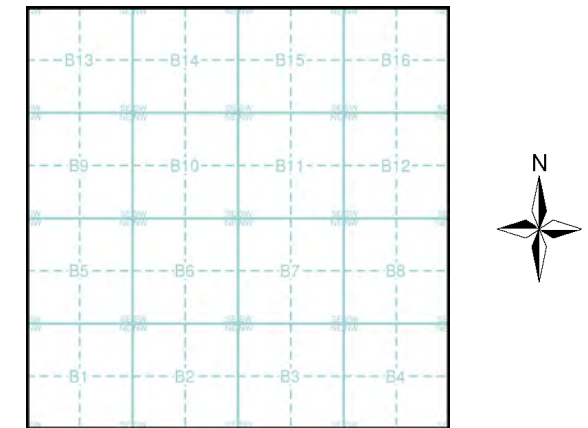

### Order Details

Order Number: 345196291\_1\_1  
 Customer Ref: PO01119  
 National Grid Reference: 516350, 209600  
 Slice: B  
 Site Area (Ha): 51.71  
 Search Buffer (m): 1000

### Site Details

St Albans

